

Ausf. 6F

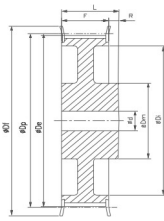

Ausf. 6WV

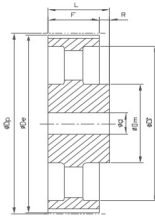

Ausf. 6A

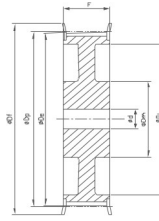

Ausf. 10WV

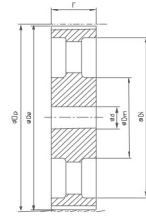

Ausf. 10A

Bezeichnung	Anzahl der Zähne	Ausführung	Material	D _p (mm)	D _s (mm)	D _f (mm)	F (mm)	L (mm)	D _m (mm)	D _i (mm)	Vorbereitung d (mm)	Fertigbohrung d _{max} (mm)
8M - Teilung 8 mm für Riemenbreite 20 mm												
22 8M 20	22	6F	ST	56,02	54,65	60	28	38	43	-	12	30
24 8M 20	24	6F	ST	61,12	59,75	66	28	38	45	-	12	30
26 8M 20	26	6F	ST	66,21	64,84	70	28	38	48	-	12	35
28 8M 20	28	6F	ST	71,30	70,08	75	28	38	50	-	15	35
30 8M 20	30	6F	ST	76,39	75,13	83	28	38	55	-	15	35
32 8M 20	32	6F	ST	81,49	80,16	87	28	38	60	-	15	40
34 8M 20	34	6F	ST	86,58	85,22	91	28	38	70	-	15	45
36 8M 20	36	6F	ST	91,67	90,30	97	28	38	75	-	15	45
38 8M 20	38	6F	ST	96,77	95,39	102	28	38	75	-	15	45
40 8M 20	40	6F	ST	101,86	100,49	106	28	38	75	-	15	45
44 8M 20	44	6F	ST	112,05	110,67	120	28	38	75	-	15	45
48 8M 20	48	6F	ST	122,23	120,86	127	28	38	75	-	15	45
56 8M 20	56	6WV	ST	142,60	141,23	150	28	38	80	116	15	45
64 8M 20	64	6WV	ST	162,97	161,60	168	28	38	80	137	15	45
72 8M 20	72	6WV	ST	183,35	181,97	192	28	38	80	158	15	45
80 8M 20	80	6W	GG	203,72	202,35	-	28	38	90	180	15	50
90 8M 20	90	6A	GG	229,18	227,81	-	28	38	90	204	15	50
112 8M 20	112	6A	GG	285,21	283,83	-	28	38	90	254	18	50
144 8M 20	144	6A	GG	366,69	365,32	-	28	38	90	336	20	50
168 8M 20	168	6A	GG	427,81	426,44	-	28	38	100	400	20	55
192 8M 20	192	6A	GG	488,92	487,55	-	28	38	100	460	20	55
8M - Teilung 8 mm für Riemenbreite 30 mm												
22 8M 30	22	6F	ST	56,02	54,65	60	38	48	43	-	12	30
24 8M 30	24	6F	ST	61,12	59,75	66	38	48	45	-	12	30
26 8M 30	26	6F	ST	66,21	64,84	70	38	48	48	-	12	35
28 8M 30	28	6F	ST	71,30	70,08	75	38	48	50	-	15	35
30 8M 30	30	6F	ST	76,39	75,13	83	38	48	55	-	15	35
32 8M 30	32	6F	ST	81,49	80,16	87	38	48	60	-	15	40
34 8M 30	34	6F	ST	86,58	85,22	91	38	48	70	-	15	45
36 8M 30	36	6F	ST	91,67	90,30	97	38	48	75	-	15	45
38 8M 30	38	6F	ST	96,77	95,39	102	38	48	75	-	15	45
40 8M 30	40	6F	ST	101,86	100,49	106	38	48	75	-	15	45
44 8M 30	44	6F	ST	112,05	110,67	120	38	48	75	-	15	45
48 8M 30	48	6F	ST	122,23	120,86	128	38	48	75	-	15	45
56 8M 30	56	6WV	ST	142,60	141,23	150	38	48	90	116	15	50
64 8M 30	64	6WV	ST	162,97	161,60	168	38	48	90	137	15	50
72 8M 30	72	6WV	ST	183,35	181,97	192	38	48	95	158	15	50
80 8M 30	80	6W	GG	203,72	202,35	-	38	48	100	180	15	55
90 8M 30	90	6A	GG	229,18	227,81	-	38	48	100	204	15	55
112 8M 30	112	6A	GG	285,21	283,83	-	38	48	100	254	18	55
144 8M 30	144	6A	GG	366,69	365,32	-	38	48	100	336	20	55
168 8M 30	168	6A	GG	427,81	426,44	-	38	48	100	400	20	55
192 8M 30	192	6A	GG	488,92	487,55	-	38	48	100	460	20	55

